



PUBLIC

# Mastering SAPUI5 Dependencies for SAP Screen Personas

An in-depth guide for designing advanced SAPUI5 version- agnostic solutions with SAP Screen Personas Slipstream Engine

## Authors

- Bernal, Conrad
- Hoznek, Tamas
- Magons, Krists
- Spielvogel, Peter
- Whassom, Anna

## Version History

1.0	June 2020	Initial version based on the release of SAP Screen Personas 3.0 SP11 Please let us know if you have any suggestions: <a href="mailto:sapscreenpersonas@sap.com">sapscreenpersonas@sap.com</a>
2.0	September 2022	General update based on the release of SAP Screen Personas 3.0 SP15

## Who is this guide for?

- Enterprise architects, developers, system administrators, customers and partners looking to provide the SAP Fiori look and feel to classic applications

## Prerequisites

We recommend that you have experience building flavors with SAP Screen Personas. In addition, we recommend that you have completed the following openSAP courses:

- [Adapting the UI in SAP S/4HANA Cloud Using SAP Screen Personas \(2022\)](#) or
- [Introduction to SAP Screen Personas \(2017\)](#)
- [Building Mobile Applications with SAP Screen Personas \(2018\)](#)
- [Using SAP Screen Personas for Advanced Scenarios \(2017\)](#)

THE BEST RUN





# TABLE OF CONTENTS

INTRODUCTION .....	4
SAPUI5 VERSION SUPPORT FOR SAP SCREEN PERSONAS.....	5
SAPUI5 Version Support for the SAP Screen Personas Client.....	5
SAPUI5 Version Support for Slipstream Engine Runtime .....	6
<i>SAPUI5 Version Requirements When Using Slipstream Engine Together with SAP Screen Personas Client</i> .....	6
<i>SAPUI5 Version Requirements When Using Slipstream Engine in SAP Fiori Launchpad</i> .....	6
DETERMINING INSTALLED SAPUI5 VERSIONS FOR THE SLIPSTREAM ENGINE ENVIRONMENT.....	8
CONFIGURING SAPUI5 VERSIONS FOR THE SAP SCREEN PERSONAS ENVIRONMENT .....	10
Configure Slipstream Engine Runtime to Load Specific SAPUI5 Library Version .....	10
Configuring SAPUI5 Version for SAP Fiori Launchpad .....	11
CONSIDERATIONS REGARDING SAPUI5 VERSION COMPATIBILITY WITH SLIPSTREAM ENGINE FLAVORS.....	12
Considerations When Using SAPUI5 Themes in Slipstream Engine Runtime .....	13
Leveraging SAPUI5 API in SAP Screen Personas Scripts .....	14
SUMMARY .....	16
ADDITIONAL RESOURCES.....	16

## INTRODUCTION

Many customers use SAP Screen Personas with Slipstream Engine to personalize and render classic SAP apps to enable a simpler, more consistent user experience and provide the SAP Fiori look and feel to end users.

Slipstream Engine uses SAPUI5 HTML5 framework technology to render web-enabled transactions. The goal of this guide is to provide a deep dive into SAPUI5 version-specific requirements and considerations for creating and deploying SAP Screen Personas flavors.

## SAPUI5 VERSION SUPPORT FOR SAP SCREEN PERSONAS

Regarding the SAPUI5 support for SAP Screen Personas, note that SAP Screen Personas uses the SAPUI5 framework for two of its major components:

- The SAP Screen Personas client: this comprises flavor, script, and theme editors, the flavor manager, and the other SAP Screen Personas facilities that are accessible when users click the SAP Screen Personas **P** button in a browser
- The Slipstream Engine runtime environment: this renders classic applications using the SAPUI5 technology. Optionally, SAP Screen Personas personalization changes can be applied.

The SAP Screen Personas client and Slipstream Engine components can be loaded either independently or in conjunction with each other. The two components have different dependency requirements regarding the SAPUI5 version. Here are a few examples of different use cases:

- SAP Screen Personas without Slipstream Engine: SAP Screen Personas loads with SAP GUI for HTML. Slipstream Engine components are not loaded.
- Slipstream Engine without SAP Screen Personas: Slipstream Engine is loaded in SAP Fiori launchpad. The client components of SAP Screen Personas are not loaded.
- Used together: The SAP Screen Personas flavor editor can be used to personalize Slipstream Engine screens. Both SAP Screen Personas client and Slipstream Engine components are loaded in a single page application sharing the same SAPUI5 instance.

### SAPUI5 Version Support for the SAP Screen Personas Client

The SAP Screen Personas client is loaded and enabled when you use Slipstream Engine or SAP GUI for HTML through dedicated SICF services, such as `/sap/bc/se/m` or `/sap/bc/personas`. When you use Slipstream Engine from SAP Fiori launchpad, the SAP Screen Personas client isn't available. You can only create Slipstream Engine flavors when you use the standalone SICF service outside of SAP Fiori launchpad.

Each SAP Screen Personas service pack comes with a slightly customized SAPUI5 version that can be loaded from the `/sap/bc/personas3/ui5` service on your SAP ABAP back-end system. The SAPUI5 version that is shipped with SAP Screen Personas is used for the following:

- Rendering the SAP Screen Personas client when you personalize classic applications for SAP GUI for HTML
- Rendering of Slipstream Engine and the SAP Screen Personas client when you personalize classic applications for Slipstream Engine
- As an optional SAPUI5 dependency for custom SAP Screen Personas scripts

By default, when running the SAP Screen Personas client with Slipstream Engine, the SAPUI5 version that is loaded by Slipstream Engine is also used to render the SAP Screen Personas client. For more information, see the section [Configuring SAPUI5 versions for Slipstream Engine Environment](#).

In the table below, you can see the default SAPUI5 versions shipped with different SAP Screen Personas versions and loaded from the `/sap/bc/personas3/ui5` service.

Table 1 SAPUI5 Versions Delivered with SAP Screen Personas Releases

Service Pack Version	SAPUI5 Version
SP10	1.65.8
SP11	1.65.8
SP12	1.65.8
SP13	1.84.4
SP14	1.84.4
SP15	1.96.4

The usage of other SAPUI5 versions for the SAP Screen Personas client is not supported.

## SAPUI5 Version Support for Slipstream Engine Runtime

Slipstream Engine is a component of the SAP Screen Personas installation that can be used:

- In conjunction with the SAP Screen Personas client when creating flavors for classic applications.
- In SAP Fiori launchpad to render the previously created flavors or original screens. The rendering of Slipstream Engine flavors does not require the SAP Screen Personas client that is used to design flavors.

### **SAPUI5 Version Requirements When Using Slipstream Engine Together with SAP Screen Personas Client**

When using Slipstream Engine together with the SAP Screen Personas client, the same SAPUI5 requirements for the SAP Screen Personas client apply. The default SAPUI5 version will be loaded independently of the SAPUI5 version installed on the SAP ABAP front-end system and used, for example, by SAP Fiori launchpad.

In this scenario, the default SAPUI5 version of the service pack indicated in table [1] is loaded from the `/sap/bc/personas3/ui5` service and the framework instance is then shared between Slipstream Engine and the client components of SAP Screen Personas in a single-page application setting. As mentioned previously, this scenario does not support SAP Fiori launchpad integration using the SAP Fiori application type (SAPUI5-based apps) for Slipstream Engine tiles.

As an SAP Screen Personas flavor builder, you can load different SAPUI5 versions to test how Slipstream Engine renders flavors using the same SAPUI5 version that is installed on the SAP ABAP front-end system for rendering Slipstream Engine applications deployed in SAP Fiori launchpad. For more information, see the [\*Slipstream Engine Flavor SAPUI5 Version Compatibility Considerations\*](#).

### **SAPUI5 Version Requirements When Using Slipstream Engine in SAP Fiori Launchpad**

Slipstream Engine can be used to render SAP Screen Personas flavors as tiles in SAP Fiori launchpad using the SAP Fiori app type that is based on SAPUI5. In this case, the SAPUI5 version that is installed on your SAP ABAP front-end server is used to render Slipstream Engine applications. The table below shows the SAPUI5 versions that are currently compatible with the Slipstream Engine runtime environment.

Table 2 SAPUI5 versions supported by Slipstream Engine runtime

SAPUI5 Version	SP10	SP11	SP12	SP13	SP14	SP15
1.44.x <sup>1</sup>	X					
1.52.x <sup>1</sup>	X	X				
1.60.x <sup>1</sup>	X	X	X	X	X	
1.65.x <sup>1</sup>	X	X	X			
1.71.x	X	X	X	X	X	X
1.72.x <sup>1</sup>		X				
1.78.x <sup>1</sup>		X	X			
1.84.x				X	X	X
1.96.x						X

We recommend using the latest minor version. The use of SAPUI5 versions that are not listed here to render Slipstream Engine applications is not supported and may cause rendering issues.

Note that some rendering features in Slipstream Engine may require certain SAPUI5 versions that enable additional functionality. For example:

- The SAP Fiori 3 light theme requires SAPUI5 version 1.65 or above
- The SAP Fiori 3 dark theme requires SAPUI5 version 1.71 or above

---

<sup>1</sup> The SAPUI5 version support is discontinued by the SAPUI5 team. Please consider using to a newer version.

- The SAP Horizon theme requires SAPUI5 version 1.96 or above

See [Considerations of using SAPUI5 Themes in Slipstream Engine Runtime](#) for more information.

SAP Screen Personas is working to support the latest major SAPUI5 releases, such as the long-term support versions for Slipstream Engine runtime. With the release of SAP Screen Personas SP11, the SAPUI5 version management has been significantly improved, enabling faster support for new SAPUI5 versions. We recommend that you review the latest SAPUI5 version support information available in the SAP Note for the installed service pack version. For example, the SAP Screen Personas SP15 SAPUI5 requirements are available in the [SAP Note 3201065](#)

Note that a specific SAPUI5 version support for Slipstream Engine is aligned with the corresponding SAPUI5 support schedule. We cannot provide technical support for rendering issues of Slipstream Engine that are related to using a discontinued SAPUI5 version. Check [the SAPUI5 Versions Maintenance Status](#) for the SAPUI5 support schedule.

## DETERMINING INSTALLED SAPUI5 VERSIONS FOR THE SLIPSTREAM ENGINE ENVIRONMENT

With the release of SAP Screen Personas SP10, we have included two new System Status entries in the *Personas Admin* transaction's Health Check function. These display the SAP\_UI and SAPUI5 versions that are installed in the SAP ABAP system along with the add-on installation of SAP Screen Personas.

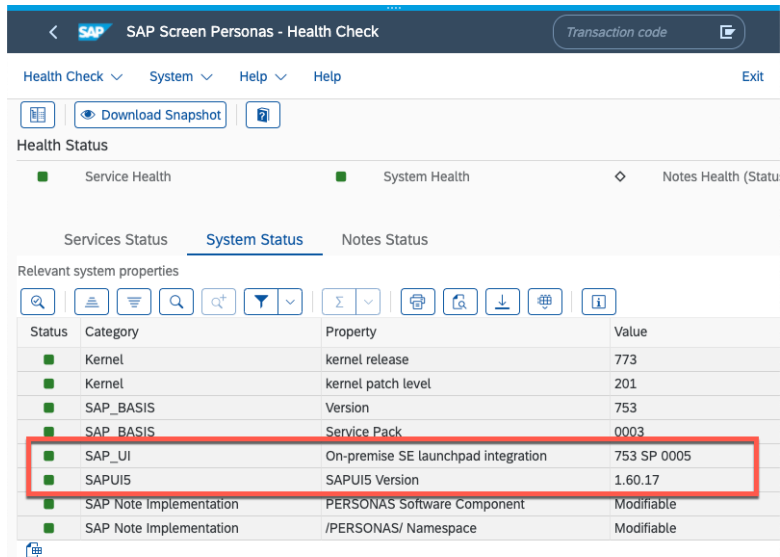

Status	Category	Property	Value
■	Kernel	kernel release	773
■	Kernel	kernel patch level	201
■	SAP_BASIS	Version	753
■	SAP_BASIS	Service Pack	0003
■	SAP_UI	On-premise SE launchpad integration	753 SP 0005
■	SAPUI5	SAPUI5 Version	1.60.17
■	SAP Note Implementation	PERSONAS Software Component	Modifiable
■	SAP Note Implementation	/PERSONAS/ Namespace	Modifiable

Figure 1 SAPUI5 and SAP\_UI Component Versions Installed in the Back-End System

The displayed SAPUI5 version is used to render SAP Fiori launchpad and SAP Fiori applications on the given SAP ABAP system. Note: In the case of an SAP Fiori launchpad Hub setup with separate SAP ABAP front-end and back-end systems, the version installed on a back-end system may be different than the one installed on the front-end system. Always check the SAPUI5 version that is installed on the front-end system.

The installed SAP user interface SAP\_UI component version determines which set of SAPUI5 versions you can use with SAP Fiori launchpad. For more information, see [SAP Note 2217489](#). If the SAPUI5 version installed on the front-end system is not supported, upgrade options are limited by the available SAP\_UI component version. In some situations, an SAP\_UI component upgrade on the front-end system may be required to ensure a SAPUI5 version that is compatible with Slipstream Engine.

Note that SAP\_UI and SAPUI5 parameter values do not affect the SAP GUI for HTML components of SAP Screen Personas or Slipstream Engine when running as a standalone SICF service outside the SAP Fiori launchpad environment.

If the SAP Screen Personas add-on is not installed on the SAP ABAP front-end system, you can determine the SAPUI5 version used by SAP Fiori launchpad to render SAP Fiori apps by doing the following:

1. Open SAP Fiori launchpad in a browser
2. Press **Ctrl+Shift+Alt+P** to bring up the SAPUI5 Technical Information dialog
3. The dialog shows the SAPUI5 version that is loaded along with the SAP Fiori launchpad instance



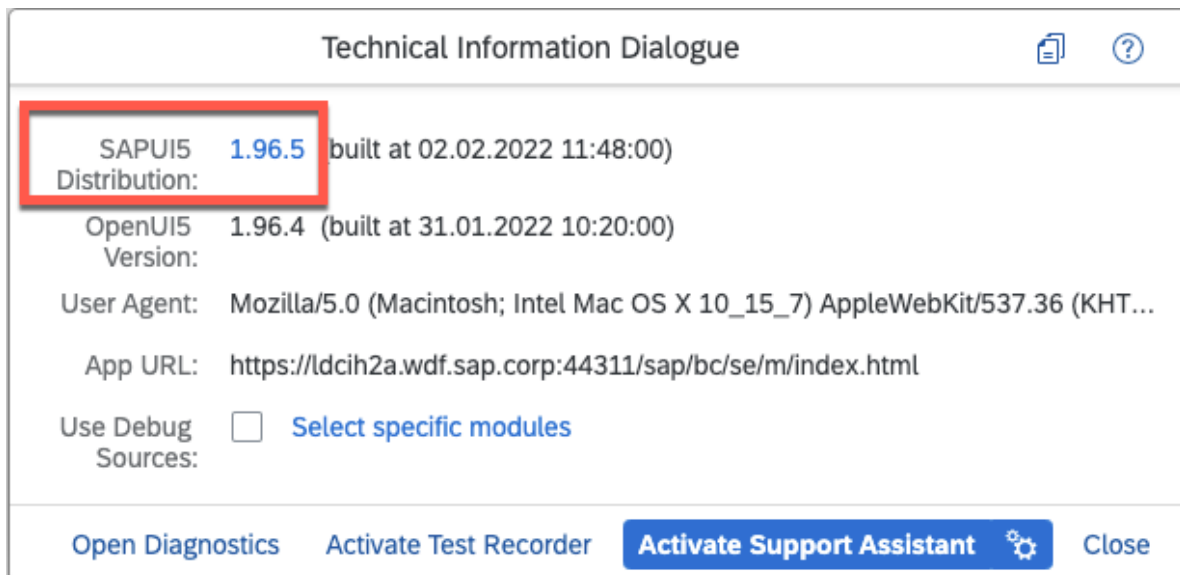

Figure 2 SAPUI5 Technical Information Dialog

## CONFIGURING SAPUI5 VERSIONS FOR THE SAP SCREEN PERSONAS ENVIRONMENT

End users cannot change the SAPUI5 version that is loaded with SAP Screen Personas in SAP GUI for HTML and it is not required for flavor rendering. No further SAPUI5 configuration is needed when creating flavors for SAP GUI for HTML.

Additional configuration to fulfill SAPUI5 dependencies for Slipstream Engine may be required for the following scenarios:

1. The SAPUI5 version in SAP Fiori launchpad is different from the SAPUI5 version that is used when creating Slipstream Engine flavors.
2. When the SAPUI5 version installed on the front-end server is not supported by Slipstream Engine when deploying flavors on SAP Fiori launchpad.

### Configure Slipstream Engine Runtime to Load Specific SAPUI5 Library Version

Sometimes it may be required to override the default SAPUI5 version that loads along with the standalone Slipstream Engine SICF service. This applies in the following cases, for example:

- Some Slipstream Engine features may require a higher SAPUI5 version than the one that is shipped with the current add-on installation of SAP Screen Personas.
- When testing the rendering and functionality of Slipstream Engine flavors with other SAPUI5 versions.

To override the SAPUI5 version that is loaded with the standalone Slipstream Engine runtime, you can either use the switchboard menu in Slipstream Engine or set the *sap-ui-version* URL parameter directly.

To open the switchboard menu in SAP Screen Personas Slipstream Engine, click on the **P** icon in the status bar. The switchboard menu, among other options, enables you to specify the desired SAPUI5 version. Note that the SAPUI5 configuration in the switchboard is only available to users with the flavor builder authorizations.

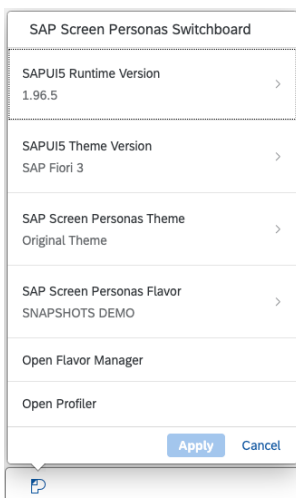

Figure 3 SAP Screen Personas Switchboard

You can also set the *sap-ui-version=<SAPUI5 version number>* parameter via the URL of your Slipstream Engine SICF service. For example, setting the parameter *sap-ui-version=1.84.4* loads the SAPUI5 version 1.84.4 from the cloud repository.

Note the following limitations:

- The *sap-ui-version* parameter cannot be used to specify the SAPUI5 dependency version of Slipstream Engine for SAP Fiori launchpad.
- The SAPUI5 version instance specified by the *sap-ui-version* parameter is shared between Slipstream Engine runtime and the SAP Screen Personas client. Although the rendering of the Slipstream Engine runtime can be tested using different SAPUI5 versions, we do not recommend using the SAP Screen Personas client with other SAPUI5 versions than those recommended. For more information, see *SAPUI5 Version Support for the SAP Screen Personas Client*.

- The custom SAPUI5 version specified by the `sap-ui-version=<SAPUI5 version number>` parameter is loaded from the cloud repository and therefore requires external network access.

### **Configuring SAPUI5 Version for SAP Fiori Launchpad**

Slipstream Engine uses the SAP Fiori application type for integration with SAP Fiori launchpad. In these scenarios, the SAPUI5 version configured for SAP Fiori launchpad is used to render SAP Fiori applications based on SAPUI5, including Slipstream Engine.

SAP Screen Personas does not provide any technical means to set the SAPUI5 versions used for on-premise Launchpad scenarios.

For SAP Fiori launchpad scenarios in on premise, see [SAP Note 2217489](#). It explains the maintenance and update strategy for SAP Fiori front-end server and outlines the required component versions that must be installed to comply with the SAPUI5 version requirements for Slipstream Engine runtime.

## CONSIDERATIONS REGARDING SAPUI5 VERSION COMPATIBILITY WITH SLIPSTREAM ENGINE FLAVORS

SAP Screen Personas flavors rendered with Slipstream Engine and created for a specific SAPUI5 version may look different when the same flavor is rendered using a different SAPUI5 version. The following issues may occur, for example:

- A completely different look and feel due to a different SAPUI5 theme being displayed
- Differently positioned elements
- Different styling
- Issues executing custom scripts due to differences in the SAPUI5 scripting API
- Other missing functionality

Figure 4 illustrates rendering differences for the same SAP Screen Personas flavor using Slipstream Engine with different SAPUI5 versions.

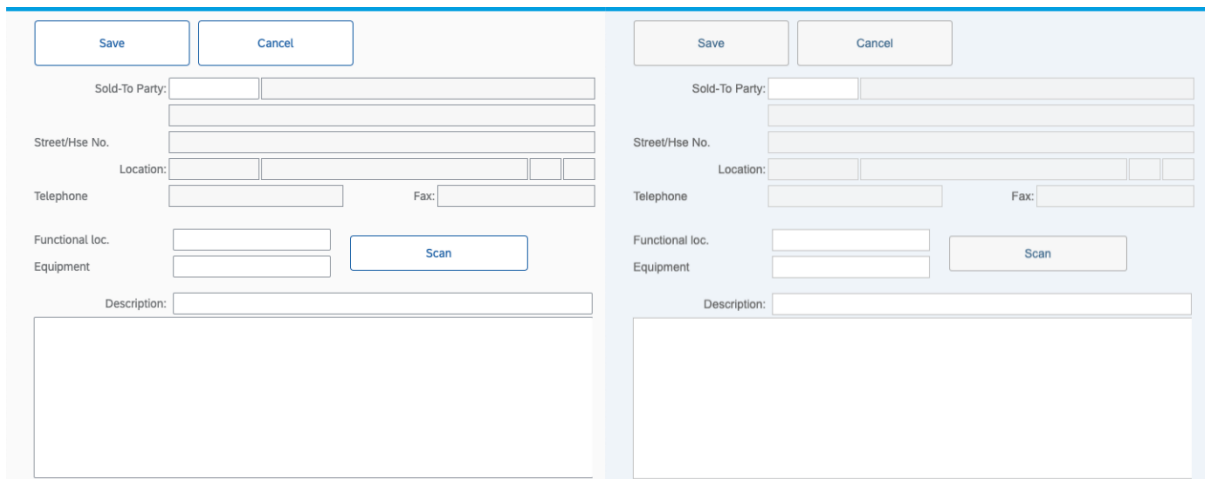

Figure 4 Slipstream Engine Rendering Differences

There are two common scenarios when customers report Slipstream Engine rendering issues that relate to SAPUI5 versions:

- Flavors look different when deployed on SAP Fiori launchpad
- Flavors look different when SAP Screen Personas is upgraded

Both situations are typically caused by one of the following factors:

- The SAPUI5 version has changed. The version used to render flavors is different than the one used when the flavor was created
- The SAPUI5 theme has changed

To ensure the best results, it is crucial to bear in mind the following:

- Know your environment when designing SAP Screen Personas flavors. Make note of the SAPUI5 version and theme used to create flavors and the target deployment configuration – the SAPUI5 version and theme configured for your SAP Fiori launchpad end users.
- Do not accept deployments of flavors built with SAP Screen Personas on SAP Fiori launchpad when the SAPUI5 version used by the SAP Fiori launchpad instance is not supported by the relevant SAP Screen Personas release.
- Always test the designed flavors using the target SAPUI5 version and theme before the flavor deployment on SAP Fiori launchpad. Use the switchboard menu or `sap-ui-version=<SAPUI5 version number>` parameter to force the standalone runtime of Slipstream Engine to load the target SAPUI5 version to test the rendering and the functionality.
- Avoid using custom scripts in SAP Screen Personas that have direct API dependencies on the SAPUI5 framework or modify the structure of the document object model (DOM) of Slipstream Engine. The API can change from one version to another, introducing functional or rendering issues. Note that SAP Screen Personas cannot provide any support for these scripts.

## Considerations When Using SAPUI5 Themes in Slipstream Engine Runtime

When designing SAP Screen Personas flavors for Slipstream Engine, it is important to consider the target SAPUI5 themes that are used to provide the overall look and feel for the created flavors. We recommend testing the rendering of a Slipstream Engine flavor for all supported SAPUI5 themes that are available for your end users to configure their individual appearance settings.

Consider the following regarding SAPUI5 theme support:

- Custom themes created using the UI Theme Designer are currently not compatible with Slipstream Engine.
- Various SAPUI5 themes provided by SAP can be used, depending on the installed SAP Screen Personas service pack and SAPUI5 version, with Slipstream Engine standalone and in SAP Fiori launchpad.
- Themes created with SAP Screen Personas can be used with any supported SAPUI5 theme and are applied on top of the loaded SAPUI5 theme.

The following table illustrates different SAPUI5 theme options that are currently compatible with Slipstream Engine runtime. The cells with gray shading indicate the default SAPUI5 theme that is used as a basis when creating new Slipstream Engine flavors for the given service pack release.

Table 3 SAPUI5 Themes Supported by Slipstream Engine Runtime

SAPUI5 Theme	sap-ui-theme Parameter Value	Min. SAPUI5 version	SP10	SP11	SP12	SP13	SP14	SP15
SAP Belize	sap_belize	1.44.x	X	X	X	X	X	X
SAP Fiori 3 Light	sap_fiori_3	1.65.x	X	X	X	X	X	X
SAP Fiori 3 Dark	sap_fiori_3_dark	1.71.x		X	X	X	X	X
High Contrast Black	sap_hcb	1.52.x		X	X	X	X	X
High Contrast White	sap_belize_hcw	1.52.x		X	X	X	X	X
SAP Horizon	sap_horizon	1.96.x						X

As previously mentioned, it is crucial to test flavor compatibility with different SAPUI5 themes to avoid potential rendering issues for end users. To do so in Slipstream Engine runtime, flavor builders can use the already mentioned switchboard menu or a combination of *sap-ui-theme* and *sap-ui-version* parameters with the URL of the Slipstream Engine SICF service to apply the target SAPUI5 theme.

For example, to render a given Slipstream Engine SP15 flavor using the SAP Horizon theme, the following additional URL parameters from Table 3 can be used: *sap-ui-version=1.96.4&sap-ui-theme=sap\_horizon*.

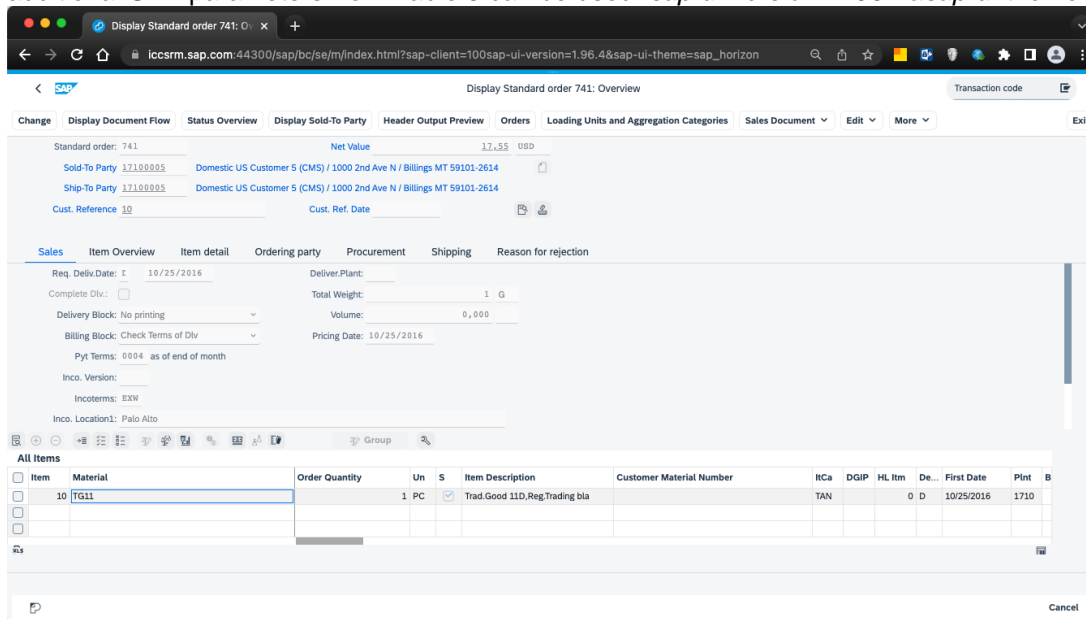

Figure 5 Slipstream Engine SAP Horizon Theme Rendering of Transaction VA03

Specifying the SAPUI5 theme in SAP Fiori launchpad is simple. In the “Appearance settings” dialog, end users can set their desired theme from the list of preconfigured themes.

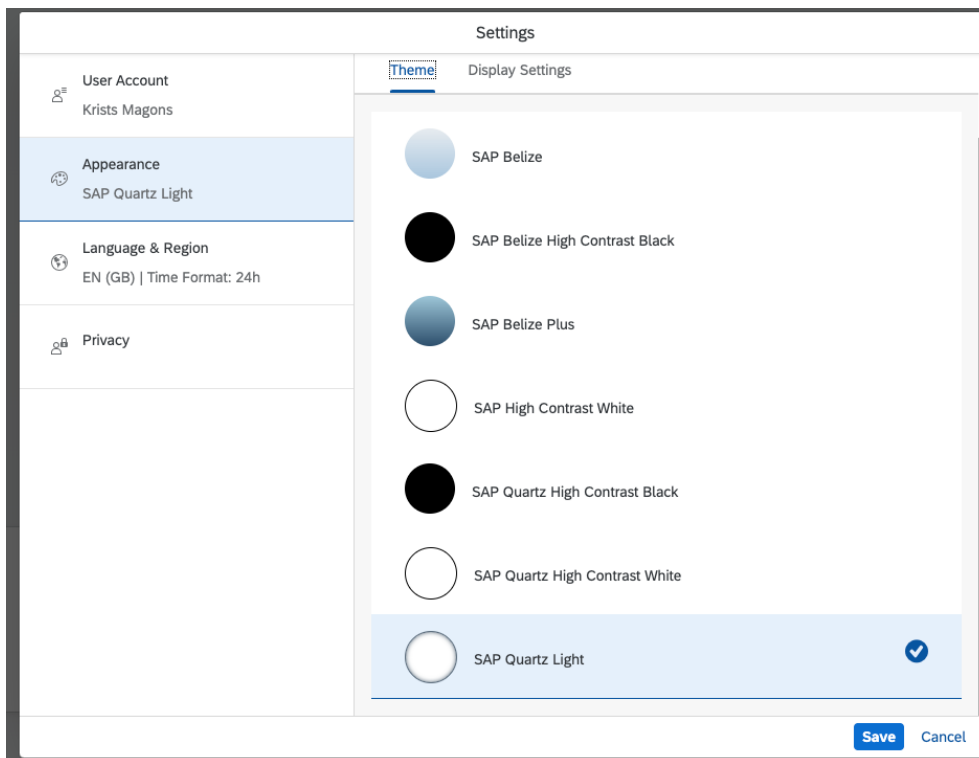

Figure 6 Setting SAP Fiori 3 Quartz Light Theme in Launchpad

## Leveraging SAPUI5 API in SAP Screen Personas Scripts

Using different SAPUI5 versions when creating Slipstream Engine flavors in the flavor editor can cause functionality issues with SAP Screen Personas scripts when consuming the flavors as tiles that are based on the SAP Fiori app type in SAP Fiori launchpad.

Use the SAP Screen Personas scripting API when implementing new functionality for Slipstream Engine flavors. Direct usage of other APIs including SAPUI5 and jQuery in SAP Screen Personas scripts may cause compatibility issues between different runtime environments and is not supported by SAP Screen Personas. Below are a few examples of SAP Screen Personas scripting scenarios that may cause compatibility or performance issues.

1. **An SAP Screen Personas flavor created for SAP GUI for HTML has an onload script that directly leverages SAPUI5 API**

```
session.utils.alert(sap.ui.version);
```

The script is successfully executed when the SAP Screen Personas client is active but fails to execute in SAP GUI for HTML when SAP Screen Personas is not loaded because SAP GUI for HTML does not require SAPUI5 dependencies to render flavors.

2. **SAPUI5 library sources being loaded twice for custom SAPUI5 applications created using GuiHtmlViewer instances:**

Use the same origin of the SAPUI5 library source domain and version that is used with Slipstream Engine to use browser caching and avoid unnecessary network requests.

```
chartHTML += '<script src="https://sapui5.hana.ondemand.com/1.60.2...'
```

In SAP Screen Personas SP15, Slipstream Engine is configured by default to load SAPUI5 version 1.94.4 from the `/sap/bc/personas3/ui5` service, however, the custom SAPUI5 application loads a different SAPUI5 version 1.60.2 from an open internet resource.

**3. A runtime environment-specific onload script for the Slipstream Engine flavor:**

```
sap.ui.getCore().getComponent("sap.se.ui").getService("ScreenService")
```

The flavor onload script will execute successfully when running Slipstream Engine outside SAP Fiori launchpad but will fail in Launchpad because the component instance of the Slipstream Engine ID is dynamically assigned.

**4. Using any SAPUI5 API functionality that is not available on all the target runtime environments of Slipstream Engine**

For example, the SAPUI5 applets feature uses the same SAPUI5 version that is loaded with Slipstream Engine. Make sure your custom applets are compatible with the target SAPUI5 version, especially when the integration of SAP Fiori launchpad and different SAPUI5 themes are being used.

## SUMMARY

SAP Screen Personas combined with Slipstream Engine is a powerful and easy-to-use tool to provide the SAP Fiori look and feel to classic applications. It enables flexible personalization and a consistent experience when rendering flavors in SAP Fiori launchpad.

For the best results, planning the deployment landscape for a flavor and SAPUI5 requirements should be part of the Slipstream Engine enablement journey.

SAP Screen Personas Flavor builders and administrators should design, create, test, deploy, and maintain solutions that are compatible with different runtime environments. In this guide, we have presented the key SAPUI5 version-related factors that need to be considered when creating and deploying Slipstream Engine flavors:

- The general SAPUI5 version and theme requirements for SAP Screen Personas and Slipstream Engine
- How to determine and configure relevant SAPUI5 versions and themes for Slipstream Engine flavor development, testing, and deployment
- Best practices when building Slipstream Engine flavors that are compatible with different SAPUI5 versions and themes

Before reporting rendering issues for SAP Fiori launchpad Slipstream Engine, please review the latest SAPUI5 version and theme requirements to ensure your configuration is supported.

## ADDITIONAL RESOURCES

- Slipstream Engine SAPUI5 Themes Support  
<https://help.sap.com/viewer/b6a24c359e2142e3a86ff405f43ba282/Current/en-US/bc491df15ca942a3a32fb35d724b4abc.html>
- Adjust Runtime Configurations with the Switchboard Menu  
[https://help.sap.com/docs/SAP\\_SCREEN\\_PERSONAS/20993a0c28654a26beb2b63b722d74f2/c26739b3a7b0415a9940ec2cb8839aa5.html?locale=en-US](https://help.sap.com/docs/SAP_SCREEN_PERSONAS/20993a0c28654a26beb2b63b722d74f2/c26739b3a7b0415a9940ec2cb8839aa5.html?locale=en-US)
- Setting Up the Slipstream Launchpad Plug-In for On Premise SAP Fiori Launchpad  
<https://help.sap.com/viewer/1024f4ede569495cb350a479ff49ad0/Current/en-US/fe49a69987524c6883c66c639736466c.html>
- SAPUI5 Versions Maintenance Status  
<https://sapui5.hana.ondemand.com/versionoverview.html>
- Integrating Custom SAPUI5 Components with SAP Screen Personas  
<https://blogs.sap.com/2021/01/08/integrating-custom-sapui5-components-with-sap-screen-personas/#>
- Planning for SAP Screen Personas with SAP S/4HANA  
<https://blogs.sap.com/2022/07/12/sap-screen-personas-roadmap-update-2022-july-sap-s-4hana-ready/>



**[www.sap.com/contactsap](http://www.sap.com/contactsap)**

© 2022 SAP SE or an SAP affiliate company. All rights reserved.

No part of this publication may be reproduced or transmitted in any form or for any purpose without the express permission of SAP SE or an SAP affiliate company.

The information contained herein may be changed without prior notice. Some software products marketed by SAP SE and its distributors contain proprietary software components of other software vendors. National product specifications may vary.

These materials are provided by SAP SE or an SAP affiliate company for informational purposes only, without representation or warranty of any kind, and SAP or its affiliated companies shall not be liable for errors or omissions with respect to the materials. The only warranties for SAP or SAP affiliate company products and services are those that are set forth in the express warranty statements accompanying such products and services, if any. Nothing herein should be construed as constituting an additional warranty.

In particular, SAP SE or its affiliated companies have no obligation to pursue any course of business outlined in this document or any related presentation, or to develop or release any functionality mentioned therein. This document, or any related presentation, and SAP SE's or its affiliated companies' strategy and possible future developments, products, and/or platform directions and functionality are all subject to change and may be changed by SAP SE or its affiliated companies at any time for any reason without notice. The information in this document is not a commitment, promise, or legal obligation to deliver any material, code, or functionality. All forward-looking statements are subject to various risks and uncertainties that could cause actual results to differ materially from expectations. Readers are cautioned not to place undue reliance on these forward-looking statements, and they should not be relied upon in making purchasing decisions.

SAP and other SAP products and services mentioned herein as well as their respective logos are trademarks or registered trademarks of SAP SE (or an SAP affiliate company) in Germany and other countries. All other product and service names mentioned are the trademarks of their respective companies. See <https://www.sap.com/copyright> for additional trademark information and notices.

**THE BEST RUN**

